

**READ FULLY BEFORE BEGINNING - IT'LL MAKE MORE SENSE!
VOR DEM ANFANG VOLLSTÄNDIG LESEN - ES WIRD MEHR SINN MACHEN!**

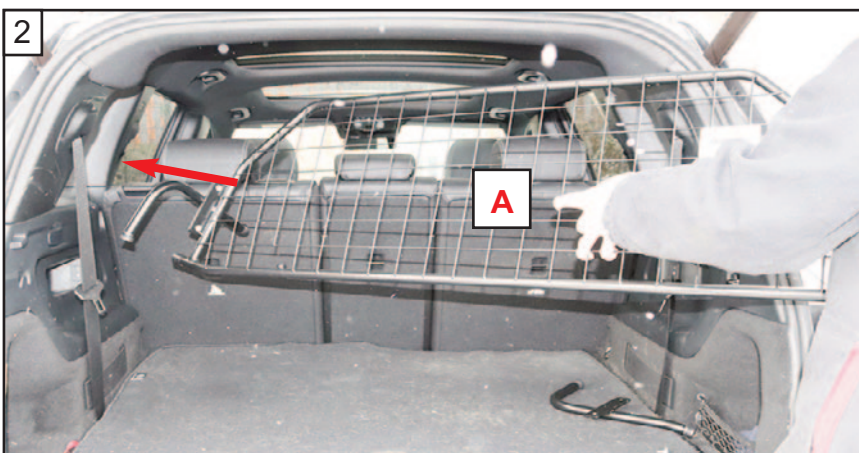
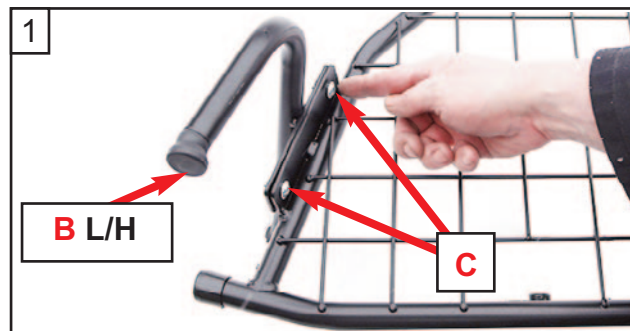
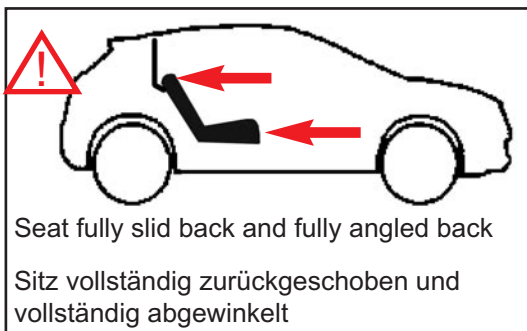

**Mercedes EQB
(2022~Onwards)
G1598-1**

**DOG GUARD
FITTING INSTRUCTION**

**HUNDESCHUTZGITTER
EINBAUANLEITUNG**

**LES GRILLES DE SEPERATION
POUR CHIENS
INSTRUCTIONS DE MONTAGE**

**HUNDEGITTER
MONTERINGSVEJLEDNING**

**CONJUNTO PROTECTOR
PARA PERROS
INSTRUCCIONES DE MONTAJE**

**KIT BARRIERA CANI
ISTRUZIONI DI MONTAGGIO**

**HUNDEVERNGITTER
MONTASJEVEILEDNING**

**HONDENBESCHERMINGSREK
INBOUWINSTRUKTIES**

**SATS HUNDSKYDD
MONTERINGSANVISNING**

**KOIRAN TURVARISTIKKO
ASENNUSOHJEET**

www.guardsmandogguards.co.uk



G1598-1 v.1 4/22



3
Insert R/H side arm.
Setzen Sie den R / H-Seitenarm ein.

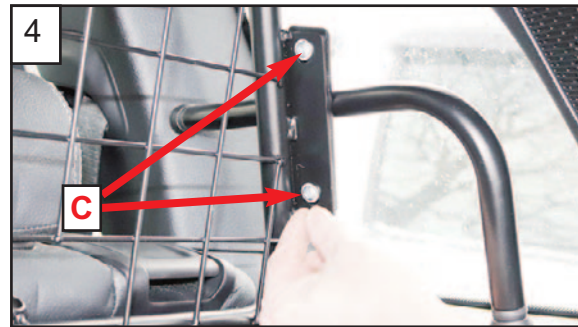

4
Insert bolts 'C'.
Schrauben 'C' einsetzen

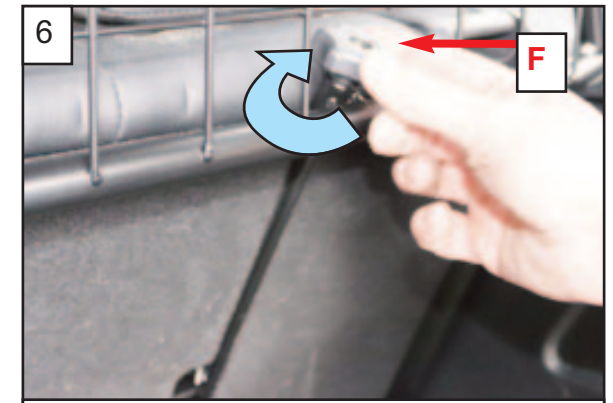
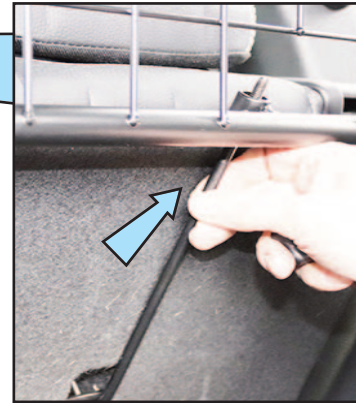
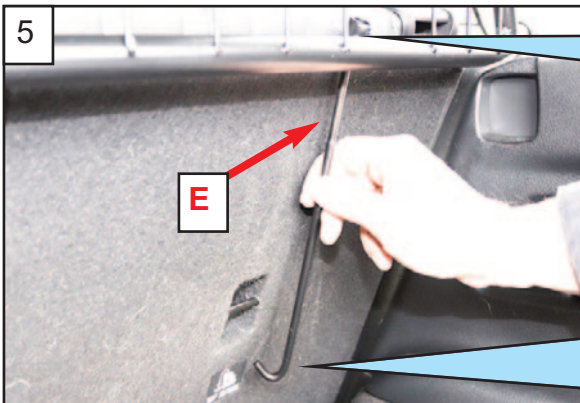

6
Tighten lower fixing hooks. Repeat for L/H side
Die unteren Befestigungshaken festziehen.
Wiederholen Sie dies für die L / H Seite

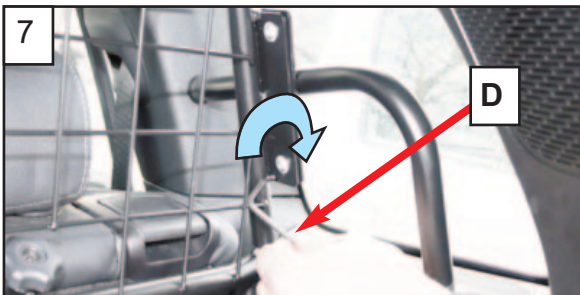

7
Tighten bolts. Repeat for R/H side
Schrauben festziehen. Wiederholen Sie dies
für die R/H Seite

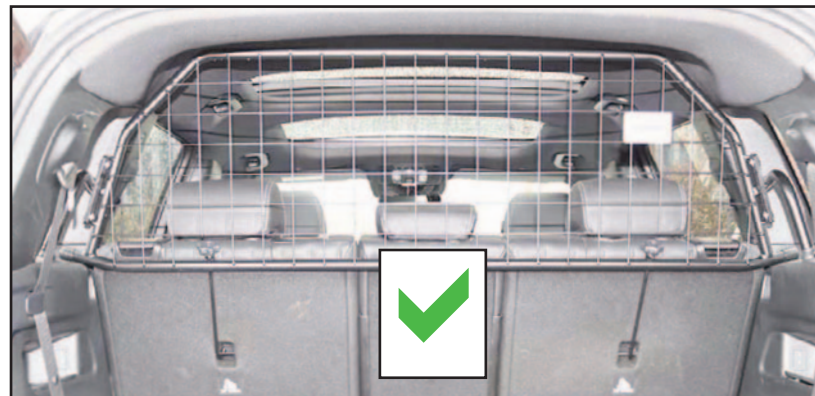

KIT



C x2



D x2



A



B x2



**Mercedes EQB
G1598-1D**

Variable Boot Divider
CAN ONLY BE USED IN
CONJUNCTION WITH GUARDSMAN
Mercedes EQB
Dog Guard
G1598-1

Kofferraum-Trenngitter

Nur mit Hundegitter Guardsman
Mercedes EQB
(Hundegitter
(Teilenummer G1598-1)
kompatibel.



**! LOOSEN FIXINGS !
! Befestigungen lösen !**

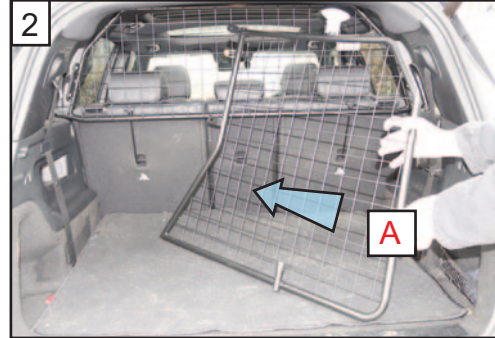

A

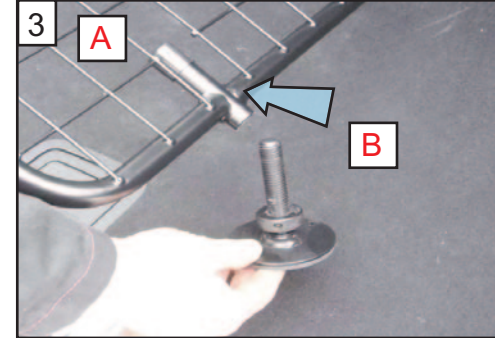

A

B



A



C

'C' Grips on opposite side of mesh.
'C' Griffe auf der gegenüberliegenden
Seite des Netzes

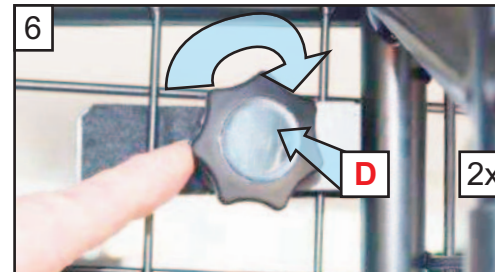

D

2x

**! Do Not fully tighten !
! Nicht fest anziehen !**

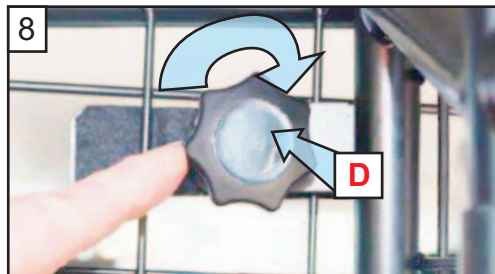
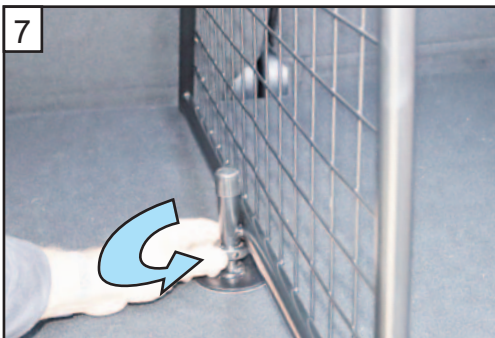

D

**! Fully tighten !
! Fest anziehen !**



**! TIGHTEN FIXINGS !
! Befestigung anziehen !**



www.guardsmandogguards.co.uk

subject to alteration without notice
G1598-1D v1 - 4/22