

**READ FULLY BEFORE BEGINNING - IT'LL MAKE MORE SENSE!  
VOR DEM ANFANG VOLLSTÄNDIG LESEN - ES WIRD MEHR SINN MACHEN!**

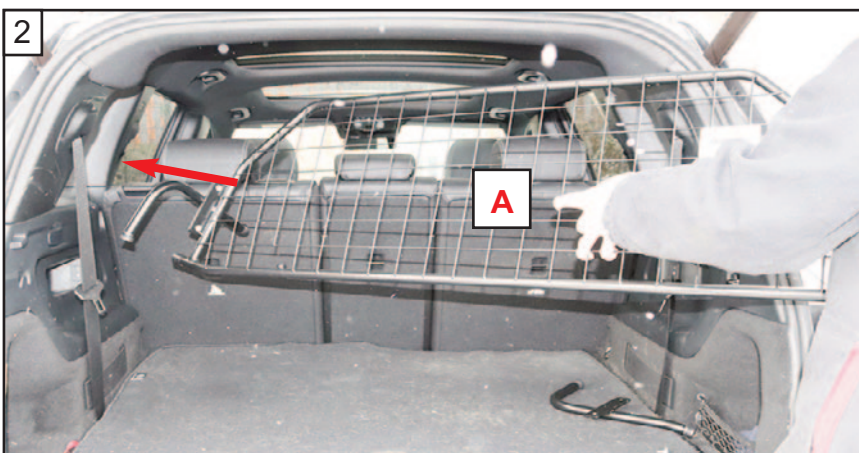
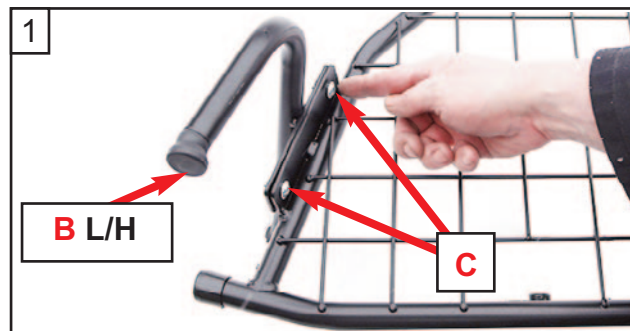
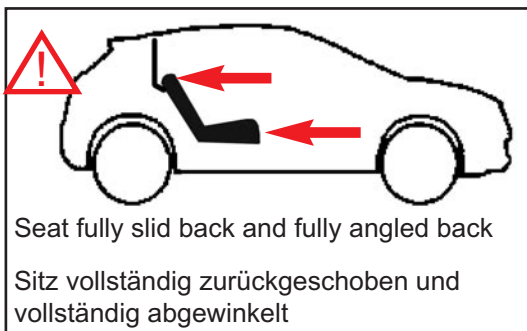

**Mercedes EQB  
(2022~Onwards)  
G1598-1**

**DOG GUARD  
FITTING INSTRUCTION**

**HUNDESCHUTZGITTER  
EINBAUANLEITUNG**

**LES GRILLES DE SEPERATION  
POUR CHIENS  
INSTRUCTIONS DE MONTAGE**

**HUNDEGITTER  
MONTERINGSVEJLEDNING**

**CONJUNTO PROTECTOR  
PARA PERROS  
INSTRUCCIONES DE MONTAJE**

**KIT BARRIERA CANI  
ISTRUZIONI DI MONTAGGIO**

**HUNDEVERNGITTER  
MONTASJEVEILEDNING**

**HONDENBESCHERMINGSREK  
INBOUWINSTRUKTIES**

**SATS HUNDSKYDD  
MONTERINGSANVISNING**

**KOIRAN TURVARISTIKKO  
ASENNUSOHJEET**

[www.guardsmandogguards.co.uk](http://www.guardsmandogguards.co.uk)



G1598-1 v.1 4/22

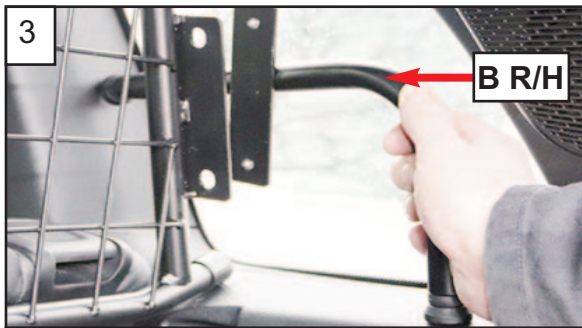

3  
Insert R/H side arm.  
Setzen Sie den R / H-Seitenarm ein.

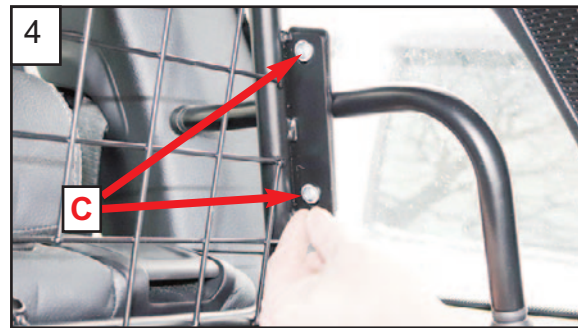

4  
Insert bolts 'C'.  
Schrauben 'C' einsetzen

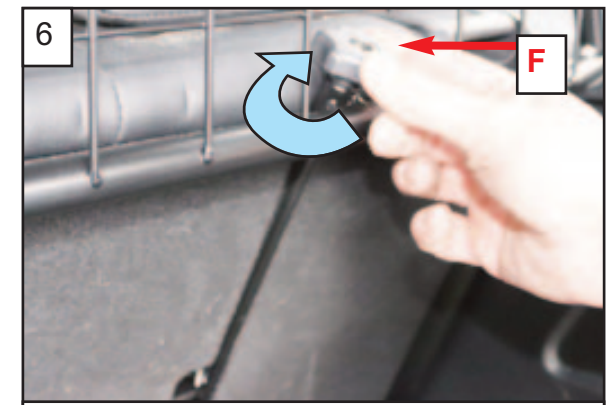
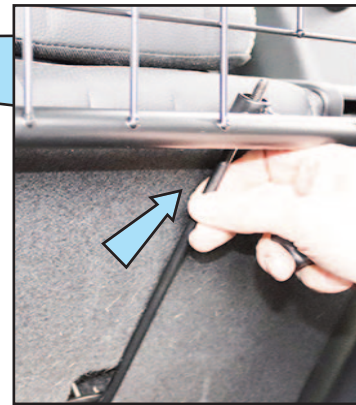

6  
Tighten lower fixing hooks. Repeat for L/H side  
Die unteren Befestigungshaken festziehen.  
Wiederholen Sie dies für die L / H Seite



7  
Tighten bolts. Repeat for R/H side  
Schrauben festziehen. Wiederholen Sie dies  
für die R/H Seite

