

**READ FULLY BEFORE BEGINNING - IT'LL MAKE MORE SENSE!
 VOR DEM ANFANG VOLLSTÄNDIG LESEN - ES WIRD MEHR SINN MACHEN!**

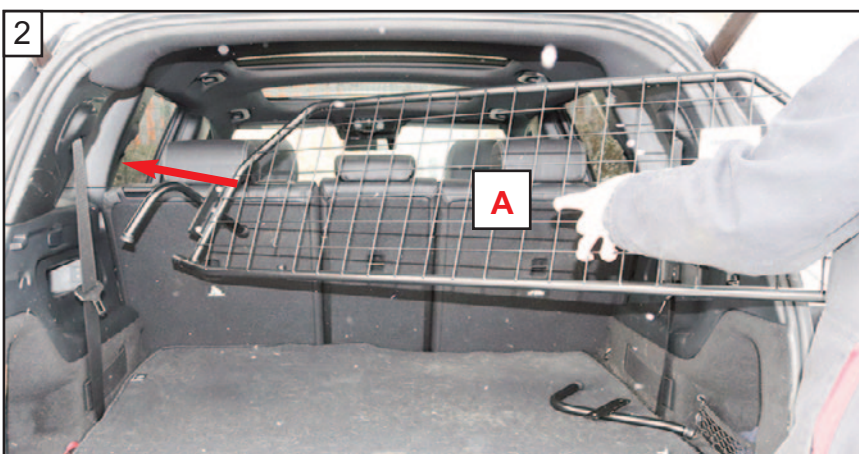

Insert the Dog guard into position behind the rear seats.
 Mesh to the rear of the car
 Setzen Sie den HundeGitter in Position hinter den Rücksitzen ein.
 Stahlgitter hinten am Auto

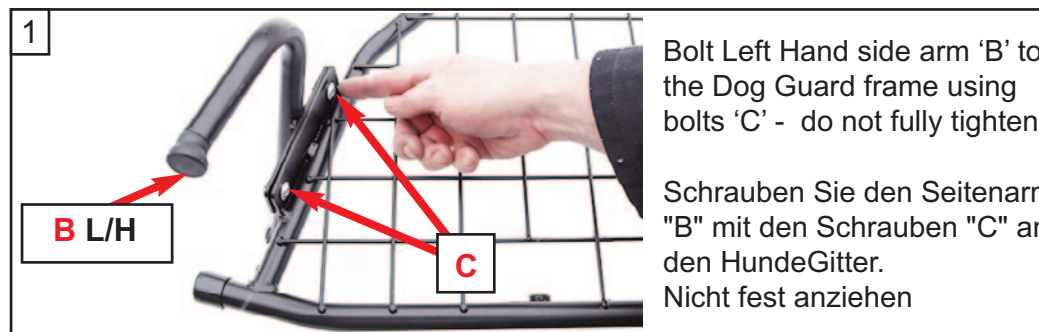

This is the required position for the Dog Guard
 Dies ist die erforderliche Position für den HundeGitter



**Mercedes GLB
 (2020~Onwards)
 G1598**

**DOG GUARD
 FITTING INSTRUCTION**

**HUNDESCHUTZGITTER
 EINBAUANLEITUNG**

**LES GRILLES DE SEPERATION
 POUR CHIENS
 INSTRUCTIONS DE MONTAGE**

**HUNDEGITTER
 MONTERINGSVEJLEDNING**

**CONJUNTO PROTECTOR
 PARA PERROS
 INSTRUCCIONES DE MONTAJE**

**KIT BARRIERA CANI
 ISTRUZIONI DI MONTAGGIO**

**HUNDEVERNGITTER
 MONTASJEVEILEDNING**

**HONDENBESCHERMINGSREK
 INBOUWINSTRUKTIES**

**SATS HUNDSKYDD
 MONTERINGSANVISNING**

**KOIRAN TURVARISTIKKO
 ASENNUSOHJEET**

www.guardsmandogguards.co.uk



G1598 v.1 2/21

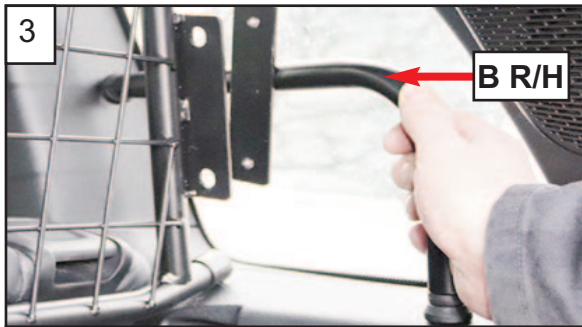

3
Insert R/H side arm.
Setzen Sie den R / H-Seitenarm ein.

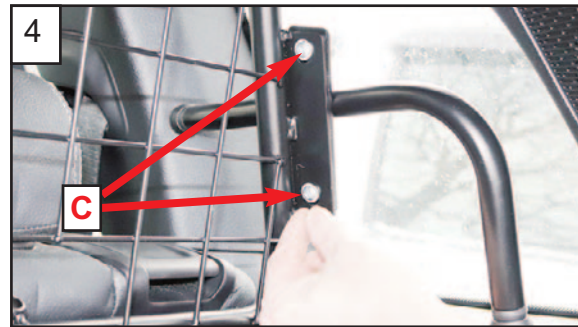

4
Insert bolts 'C'.
Schrauben 'C' einsetzen

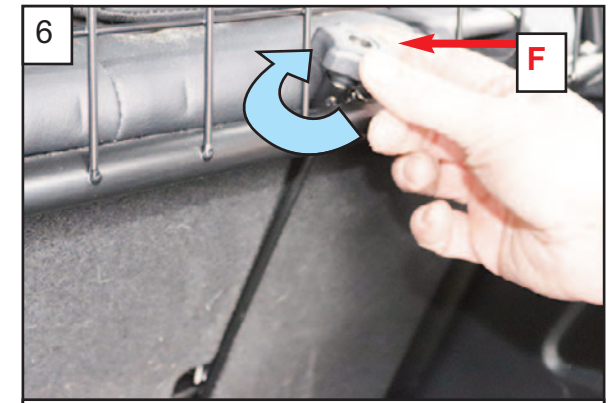
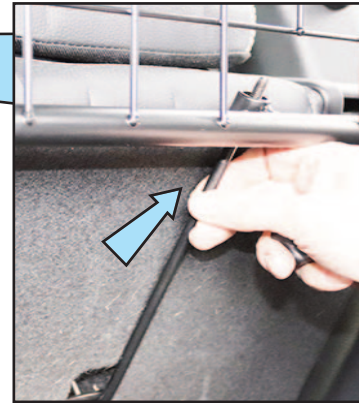
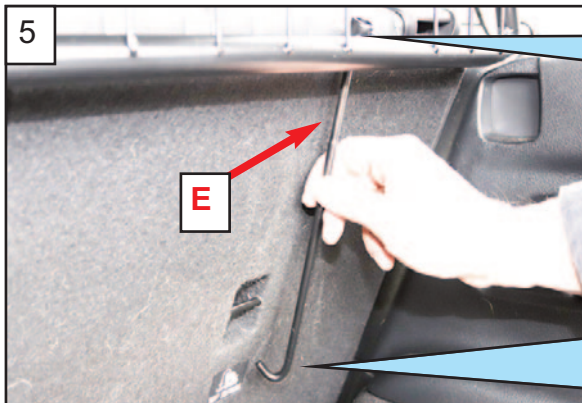

6
Tighten lower fixing hooks. Repeat for L/H side
Die unteren Befestigungshaken festziehen.
Wiederholen Sie dies für die L / H Seite

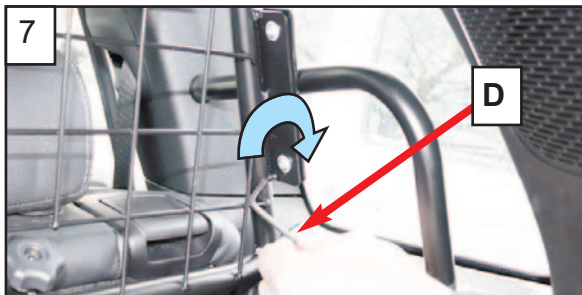

7
Tighten bolts. Repeat for R/H side
Schrauben festziehen. Wiederholen Sie dies
für die R/H Seite

