

KIT



A



B



C x2



D x2

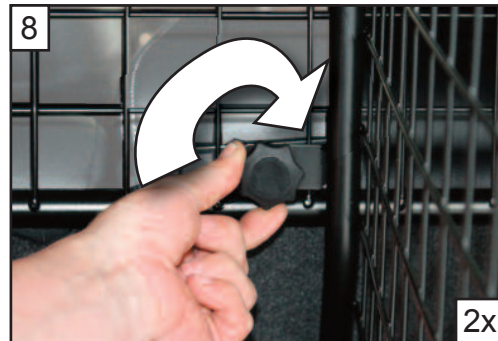
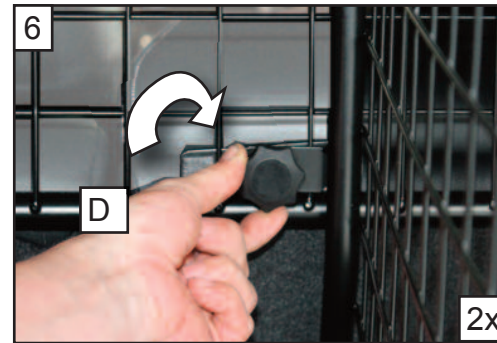
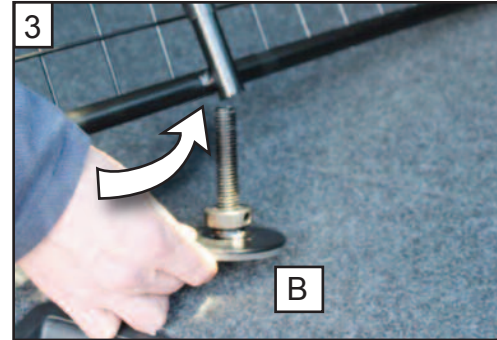
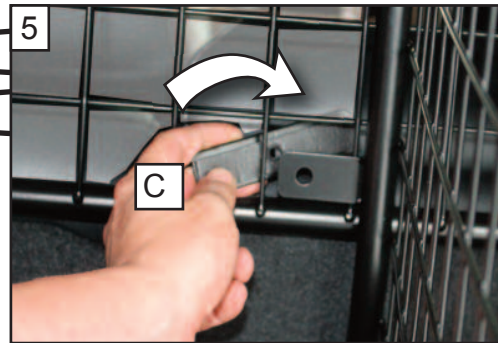
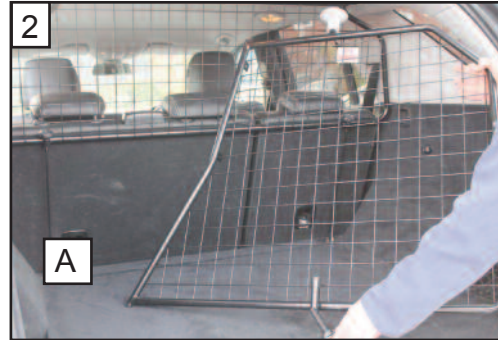

**Mercedes ML
2005-2011 (W164)
G1352D**

**BOOT DIVIDER
FITTING INSTRUCTION**

CAN BE USED IN
CONJUNCTION WITH
GUARDSMAN
Mercedes ML (W164)
Dog guard
PART No.G1352

tel no. +44 (0)1827 713040
www.dogcages.uk.com

subject to alteration without notice